

Aluminum Stamping  
 Clear Coat Aluminum,  
 Brushed Aluminum,  
 Chrome Plated

Screw driver  
 notch for  
 lens removal  
 2 Plcs

Lens is made from  
 a high performance  
 diffuse acrylic material

- Notes:
1. Operating Voltage is 13.6VDC
  2. Drive current for white LED's will be .6A
  3. Drive current for optional Red LED's is .4A
  4. Wire will be 20AWG, color coded according to LED color
  5. Use 2 #8 Oval Head Phillips screw.

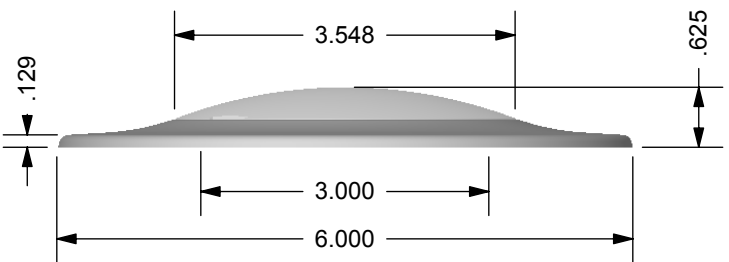

				<b>TecNiq inc</b>	
				<b>Orion Interior Light</b>	
				REV. 0	
				SHEET 1 OF 1	